



Carl Moyer Program Application

Form D-2

Marine Vessels

Shore Power : Equipment Information

If you have any questions regarding this program or the application process, please contact Greg Ushijima by phone at (909) 396-3301 or by email at: gushijima@aqmd.gov. Please complete one form for each Shore Power project.

Type of Project

Please note that if you are applying for the Purchase of Transformer and Associated Infrastructure ("Shore Side"), please use the Infrastructure application.

Vessel Retrofit to
Accept Electrical
Power
("Ship-Side")

Type Of Applicant

Existing Equipment Information

Complete one equipment section for each vessel to be retrofitted. For transformer only projects please provide a detailed description of the vessels that typically use this terminal.

If your vessel type is a refrigerated cargo ship, container-ship or passenger ship, please attach your Vessel Plan as required by the ARB shore power regulation: <http://www.arb.ca.gov/ports/shorepower/shorepower.htm>

Vessel Name

Port/Harbor

Terminal

Pier

Vessel berth/slip
number

Primary Vessel
Function

If other vessel type, please describe

Vessel Make

Vessel Model

Vessel Model Year

Total number of
main engines on
the vessel

Total number of
aux engines on the
vessel

Lloyds Register or
IMO Ship ID

US Coast Guard
Documentation
Number

If you are leasing the terminal, what is the time left on the current lease?

Average berthing time (hours) of the vessel, per visit (include time needed to connect and disconnect the vessel to shore power)

Vessel power (kW) requirements while at berth Average Power Requirement

Vessel power (kW) requirements while at berth Maximum Power Requirement



Carl Moyer Program Application
Form D-2
Marine Vessels
Shore Power : Project Details

Total Funding Requested	<input type="text"/>
Total number of vessels in the fleet	<input type="text"/>
Identify other funding sources to be used for this project	<input type="text"/>
Total Project Cost (From Quote: MUST EQUAL QUOTE)	<input type="text"/>
Applicant Co-Funding Amount	<input type="text"/>
Identify other potential project partners (ex. Port)	<input type="text"/>
Power supplier (ex. PG&E)	<input type="text"/>
Where does the electrical power infrastructure begin, and end? *	<input type="text"/>

Operation Information

Total number of annual vessel visits expected to use shore power	<input type="text"/>
Total number of annual visits to the terminal	<input type="text"/>
Total number of annual hours of usage for vessels expecting to use shorepower	<input type="text"/>

Project Funding Information

You **MUST** attach a written estimate from the equipment vendor documenting the cost of the device; this quote must be obtained within 90 days prior to the closing date of the Program Announcement. **See Attachments Section.**

Transformer Project Cost	<input type="text"/>	Associated Infrastructure Cost	<input type="text"/>
Retrofit Equip. Cost (incl. tax)	<input type="text"/>	Retrofit Equip. Installation Cost	<input type="text"/>
Total Project Costs	<input type="text"/>		

You **MUST** attach a detailed written estimate/quote from the equipment vendor for the cost of the equipment and labor.

REQUEST: MAXIMUM ALLOWABLE

- ☐ Shore Power Vessel Retrofit ("ship-side"): 100% of retrofit cost & 50% of transformer cost.

REQUEST : OTHER

☐

(You may request less than the maximum allowable funding amount to improve cost-effectiveness of your project.)

Anticipated Project Completion Date

Please attach a detailed project schedule. **SEE ATTACHMENTS PAGE**



Carl Moyer Program Application
Form D-2
Marine Vessels
Shore Power : SCAQMD Boundary Lines

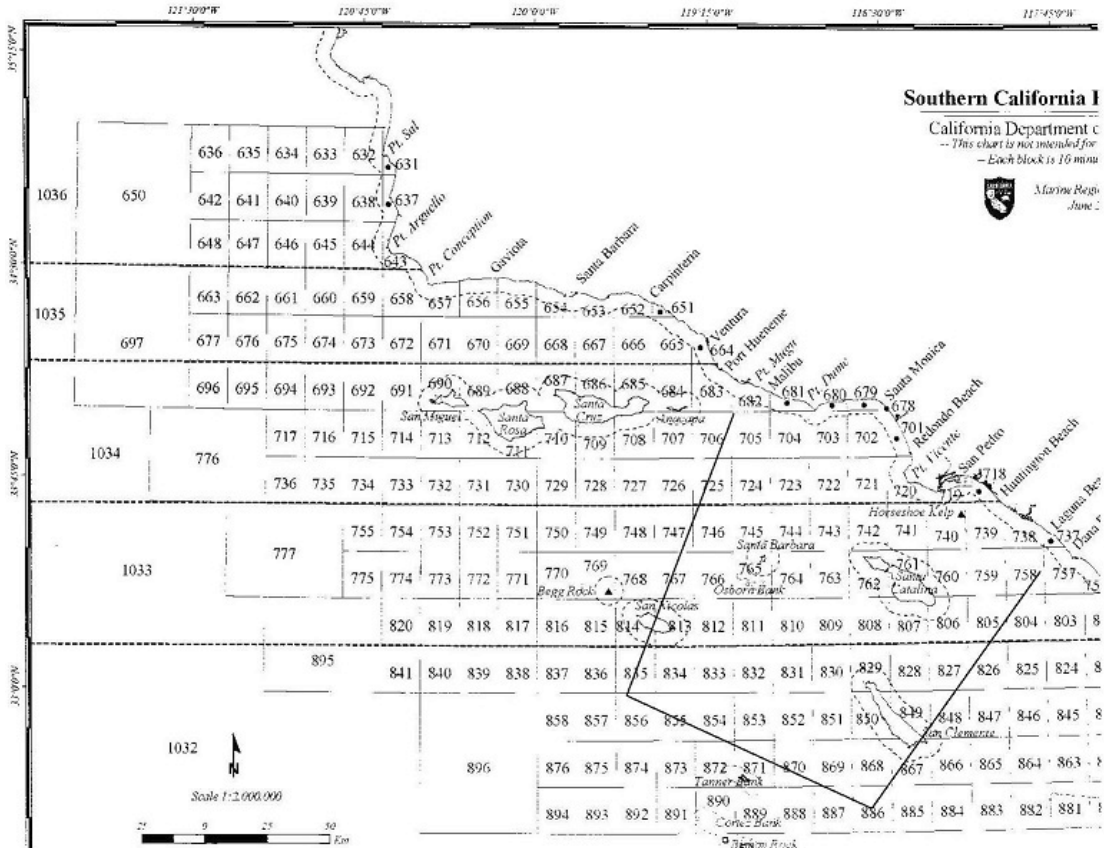

Boundary points for the Box:

Southern Coastal Boundary - San Diego - Orange County Border
Northern Coastal Boundary - Ventura - Los Angeles County Border

Northern Tip: 33° N and 119° 30' W
Southern Tip: 32° 30' N and 118° 30' W

Distance between northern coastal point and northern tip: 80 miles approx.
Distance between southern coastal point and southern tip: 74 miles approx.



Carl Moyer Program Application
Form D-2
Marine Vessels
Shore Power : Engine Information

Existing/Baseline Engine Information

Please attach a detailed description of the vessels that will be using the shore power equipment. This description should include:

- Vessel type
- Ship size (in 20-foot equivalent units (TEU) capacity)
- Number and type of engines
- Power demand (total auxiliary power (kW) – not hotelling load)
- The number of auxiliary engines typically operating while at berth per vessel
- Number of annual visits
- Average berthing time (hours) of the vessel, per visit (include time needed to connect and disconnect the vessel to shore power). Be sure to consider the maximum time the auxiliary engines are in use.



Carl Moyer Program Application
Form D-2
Marine Vessels
Shore Power : Engine Activity Information

If you have more than one engine for your project, please make copies of this page and use one form for each engine.

Project application must include documentation of existing equipment usage for the previous 24 months prior to the application date.

Activity Information

Expected annual hours

Expected annual fuel use

"Current Berth Activity" Number of annual ship visits to the berth (attach the log of vessel visits for each of the specified years): For last 3 years

Last Year Vessel Visits

Prior Year Vessel Visits

2 Years Prior Year Vessel Visits

Predicted (Future) Berth Activity:

Estimated annual ship visits using shore power:

2020

2021 and beyond

Estimated monthly hours of operation:

2020

2021 and beyond

Estimated monthly megawatt (MW) usage:

2020

2021 and beyond



Carl Moyer Program Application
Form D-2
Marine Vessels
Shore Power : Attachments

The following attachments must be submitted for this application:

- Detailed Project Proposal
- Other Miscellaneous Attachments (optional and as required by the project officer)
- ARB Shore Power Vessel Plan
- Vessel Logs
- Vessel Activity Information
- Written Estimate Or Quote
- Proposed Project Schedule
- Business Information Request Form
- Campaign Contribution Disclosure
- W-9 Form
- Direct Deposit Form
- Business Status Certification Form
- Certification of Debarment, Suspension and Other Responsibility Matters