

Quality Assurance Site Survey Report for Mira Loma (Jurupa High School)

Last updated May, 2011



AIRS Number	ARB Number	Site Start Date	Reporting Agency and Agency Code
060650004	33163	10/93- 6/11	South Coast AQMD (061)

Site Address	County	Air Basin	Latitude	Longitude	Elevation
10551 Bellegrave Ave Mira Loma, CA 91752	Riverside	South Coast	34° 0' 07"N	117° 31' 21"W	225

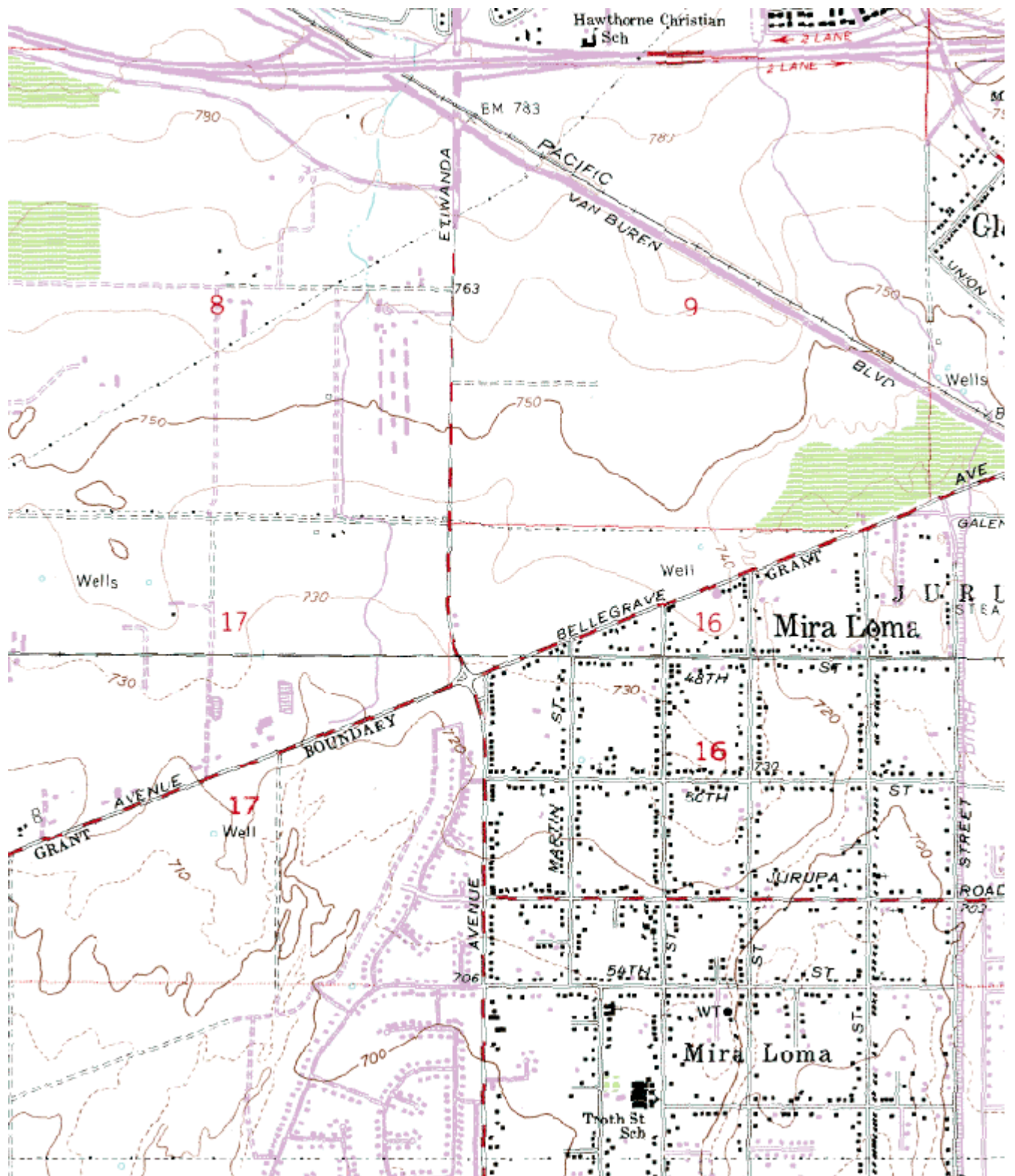

Site Survey Report

Siting Information

Site Name: Mira Loma (Jurupa High School)	Date: 5/26/11	State Code: 33163	AIRS Number: None
Address: 10551 Bellegrave Ave Mira Loma, CA 91752	Latitude: 34° 0' 07"	Longitude: 117° 31' 21"	Elevation (m): 225
	Senior AQIS: Keith Brown	Site Technician: Twyla Miner	Site Phone: (951) 360-6738
Operating Agency: South Coast AQMD			

General Siting Conditions

Station Temperature Controlled: Yes Recorded: Yes	Traffic Description: Commercial Distance: 165 meters Count (Veh/Day): 25717	Topography Site: Level	Predominant Wind Direction: SW
		Region: Level	Arc Air Flow (Deg): 360 Degrees
		QA Manual Approved: Yes Agency: South Coast AQMD Urbanization: Suburban Ground Cover: Asphalt/Dirt	Probe Last Cleaned: 05/11
Manifold Clean: Yes			
Cleaning Schedule: 6 Months			
Autocalibrator Type: Environics 100			
Meteorology Located With Instruments: No	Non-vehicular Local Sources Description: N/A Distance: N/A Direction:	Site Survey Complete: Yes	
		Logbook Up To Date: Yes	

Action Items

Comments

Detailed Site Information

Site name	Mira Loma			
AQS ID (AIRS #)	060650004			
GIS coordinates	Latitude: 34° 0' 07" Longitude: 117° 31' 21"			
Location	Jurupa Valley High School			
Address	10551 Bellegrave Ave, Mira Loma, CA 91752			
County	Riverside			
Distance to road	165 meters			
Traffic count	25717 veh/day			
Groundcover	Asphalt/Dirt			
Representative area	40140-Riverside-San Bernardino-Ontario, CA MSA			
Pollutant	Carbon Monoxide	Nitrogen Dioxide	Ozone	PM10-SSI
Site type	SLAMS	SLAMS	SLAMS	SLAMS
Monitor objective	Population Oriented	Population Oriented	Population Oriented	Population Oriented / Site Comparison
Spatial scale	Neighborhood Scale	Neighborhood Scale	Neighborhood Scale	Neighborhood Scale
Instrument type	Primary	Primary	Primary	Primary
Method code	N/A	N/A	N/A	N/A
POC code	1	1	1	1
Instrument manufacturer/model	Horiba APMA-360	API 200E	Thermo 49i	Tisch T300-310
Serial #	41346760054	261	116256	0206
Property #	16507	E000218	N/A	4962
Last calibration date	2/28/11	4/5/11	3/4/11	3/9/11
Analysis method	Non dispersive infrared	Chemiluminescence	UV Photometric	Gravimetric
Start date	10/93	10/93	10/93	11/05
Operation schedule	1:1	1:1	1:1	1:6
Sampling season	All Year	All Year	All Year	All Year
Probe height	5.0	5.0	5.0	2.6
Distance from supporting structure	1.8	1.8	1.8	1.6
Distance from obstructions on roof	2	2	2	2
Distance from obstructions not on roof	N/A	N/A	N/A	N/A
Distance from trees	N/A	N/A	N/A	N/A
Distance to furnace or incinerator flue	N/A	N/A	N/A	N/A
Distance between collocated monitors	N/A	N/A	N/A	N/A
Unrestricted airflow	No	No	No	No
Probe material	Teflon	Teflon	Teflon	N/A
Residence time	10.3	10.3	9.9	N/A
Will there be changes within the next 18 months?	Yes	Yes	Yes	Yes
Is it suitable for comparison against the annual PM2.5?	N/A	N/A	N/A	N/A

Frequency of flow rate verification for manual PM samplers audit	N/A	N/A	N/A	Monthly
Frequency of flow rate verification for automated PM analyzers audit	N/A	N/A	N/A	N/A
Frequency of one-point QC check (gaseous)	Nightly	Nightly	Nightly	N/A
Date of last annual performance evaluation	12/7/10	12/7/10	12/7/10	N/A
Dates of semi-annual flow rate audits for PM monitors	N/A	N/A	N/A	6/2/10
	N/A	N/A	N/A	12/20/10
Date of past year's PM2.5-PEP audit	N/A	N/A	N/A	N/A
Date of past year's Pb-PEP audit	N/A	N/A	N/A	N/A

Pollutant	TEOM-PM10			
Site type	SLAMS			
Monitor objective	Highest Concentration			
Spatial scale	Neighborhood Scale			
Instrument type	Audit			
Method code	079			
POC code	3			
Instrument manufacturer/model	R&P 1400A			
Serial #	20013779			
Property #	ARB 208779505			
Last calibration date	1/26/11			
Analysis method	TEOM			
Start date	10/93			
Operation schedule	1:1			
Sampling season	All Year			
Probe height	5.0			
Distance from supporting structure	1.8			
Distance from obstructions on roof	2			
Distance from obstructions not on roof	N/A			
Distance from trees	N/A			
Distance to furnace or incinerator flue	N/A			
Distance between collocated monitors	4			
Unrestricted airflow	No			

Probe material	N/A			
Residence time	N/A			
Will there be changes within the next 18 months?	Yes			
Is it suitable for comparison against the annual PM2.5?	N/A			
Frequency of flow rate verification for manual PM samplers audit	N/A			
Frequency of flow rate verification for automated PM analyzers audit	Monthly			
Frequency of one-point QC check (gaseous)	N/A			
Date of last annual performance evaluation	N/A			
Dates of semi-annual flow rate audits for PM monitors	Scheduled			
	Scheduled			
Date of past year's PM2.5-PEP audit	N/A			
Date of past year's Pb-PEP audit	N/A			

**Mira Loma
Site Photos**



Looking North from the probe.



Looking East from the probe.



Looking South from the probe.



Looking West from the probe.

**Mira Loma
Site Photos (Cont.)**



Looking at the probe from the North.



Looking at the probe from the East.



Looking at the probe from the South.



Looking at the probe from the West.